

# **HEIDELBERG – CREATIVE QUARTER**

AAR4515 URBAN DESIGN AND ARCHITECTURE STUDIO | AAR4905 URBAN LAB

PARTNER IBA HEIDELBERG

[WWW.URBANDESIGNSTUDIO.NET](http://WWW.URBANDESIGNSTUDIO.NET)







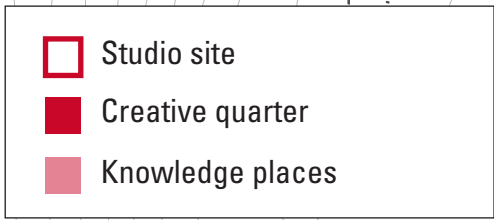
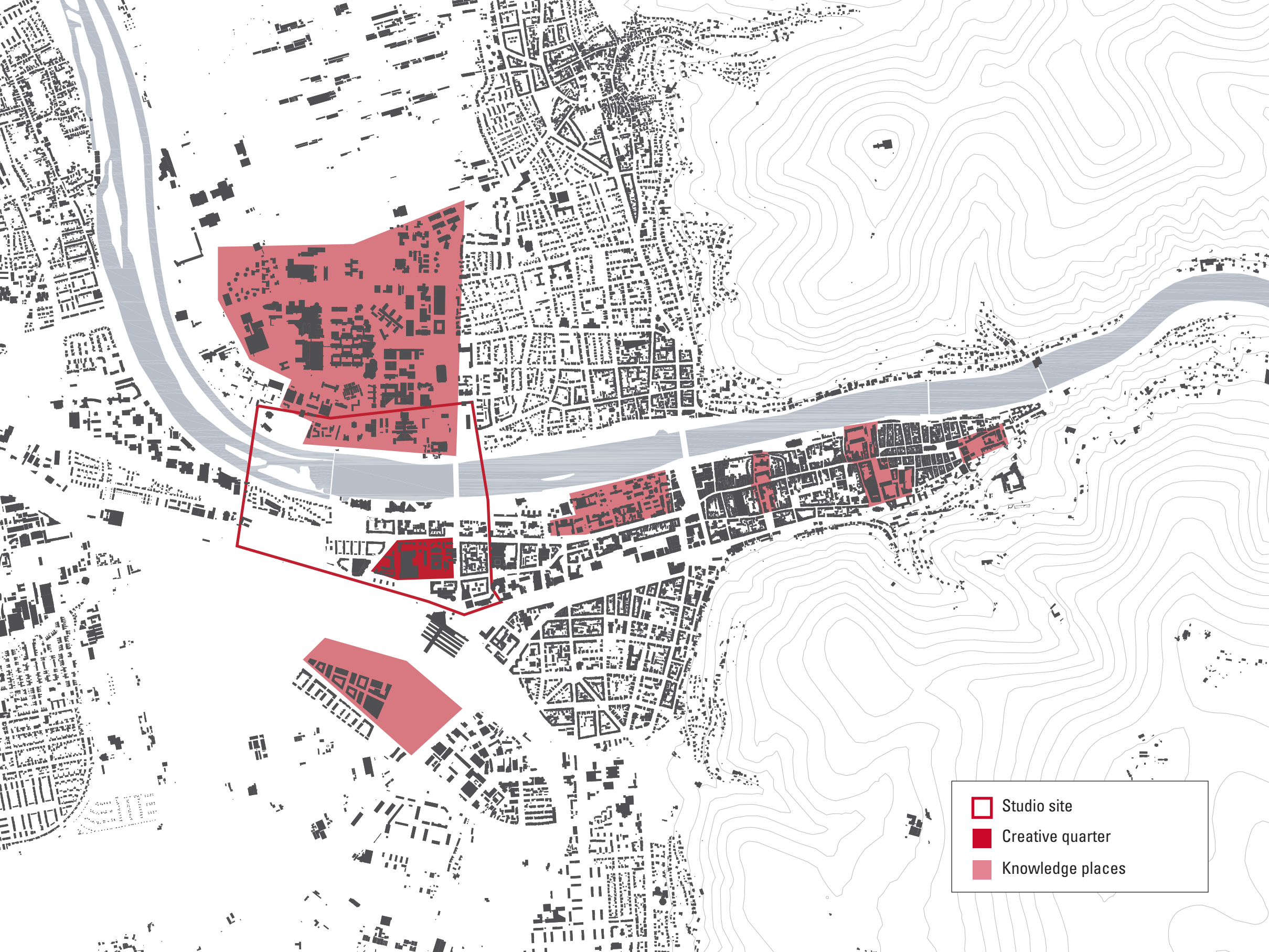







halten!

Einfahrt freihalten!

Einfahrt freihalten!

Einfahrt freihalten!

APOTHEKE





P  
→  
↓  
↓

Ein- und Ausfahrt  
Tag und Nacht  
Freihalten

HDI-MT 84

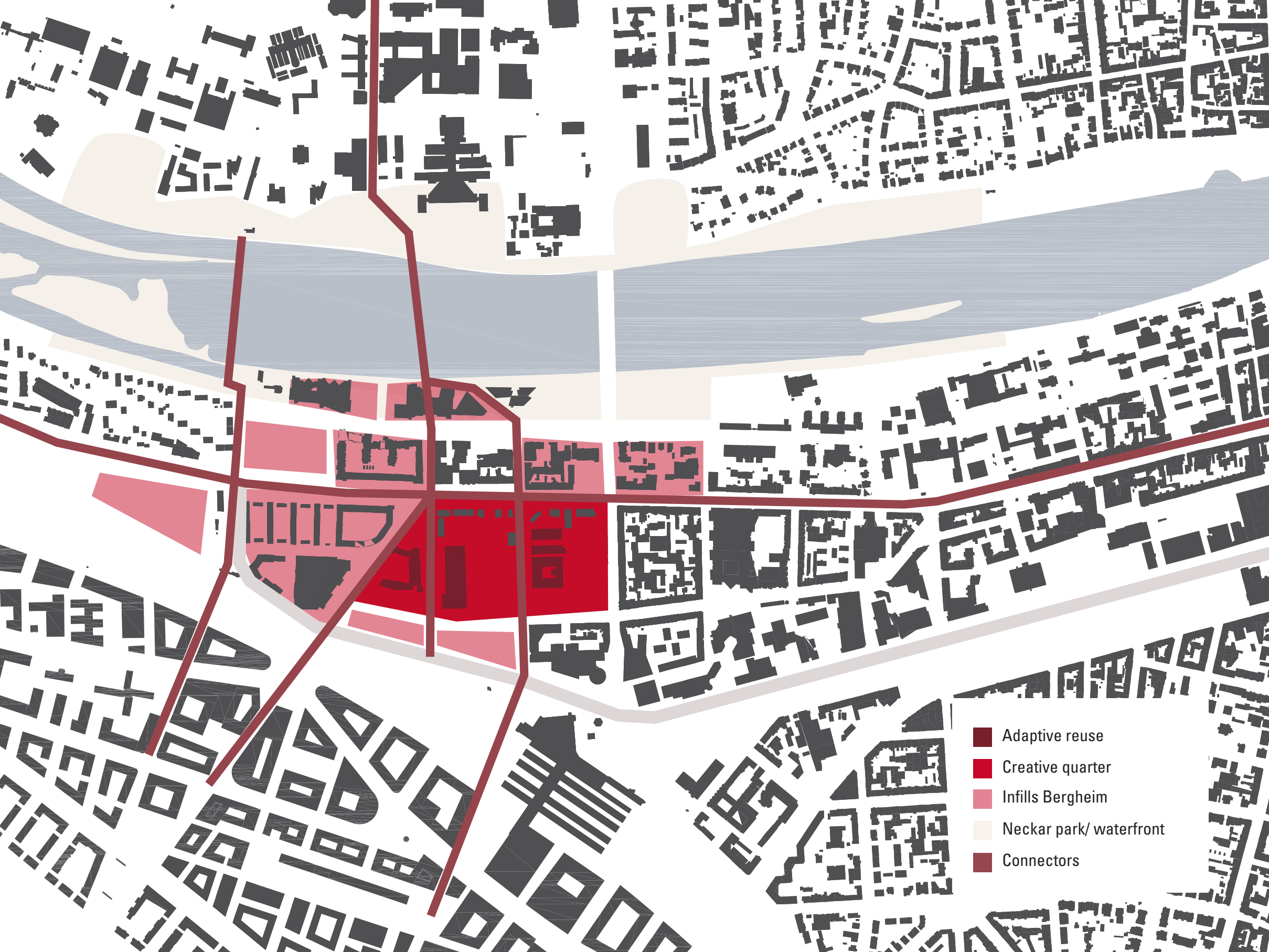

- Adaptive reuse
- Creative quarter
- Infills Bergheim
- Neckar park/ waterfront
- Connectors



International IBA Academy and Summit Heidelberg | March 2014



**Team Norway | Kerstin Höger, Magnus Jørgensen, Astrid Johnsen, Marianne Knapskog, Bjarte Lykke, Øystein Rø, Celia Seim**

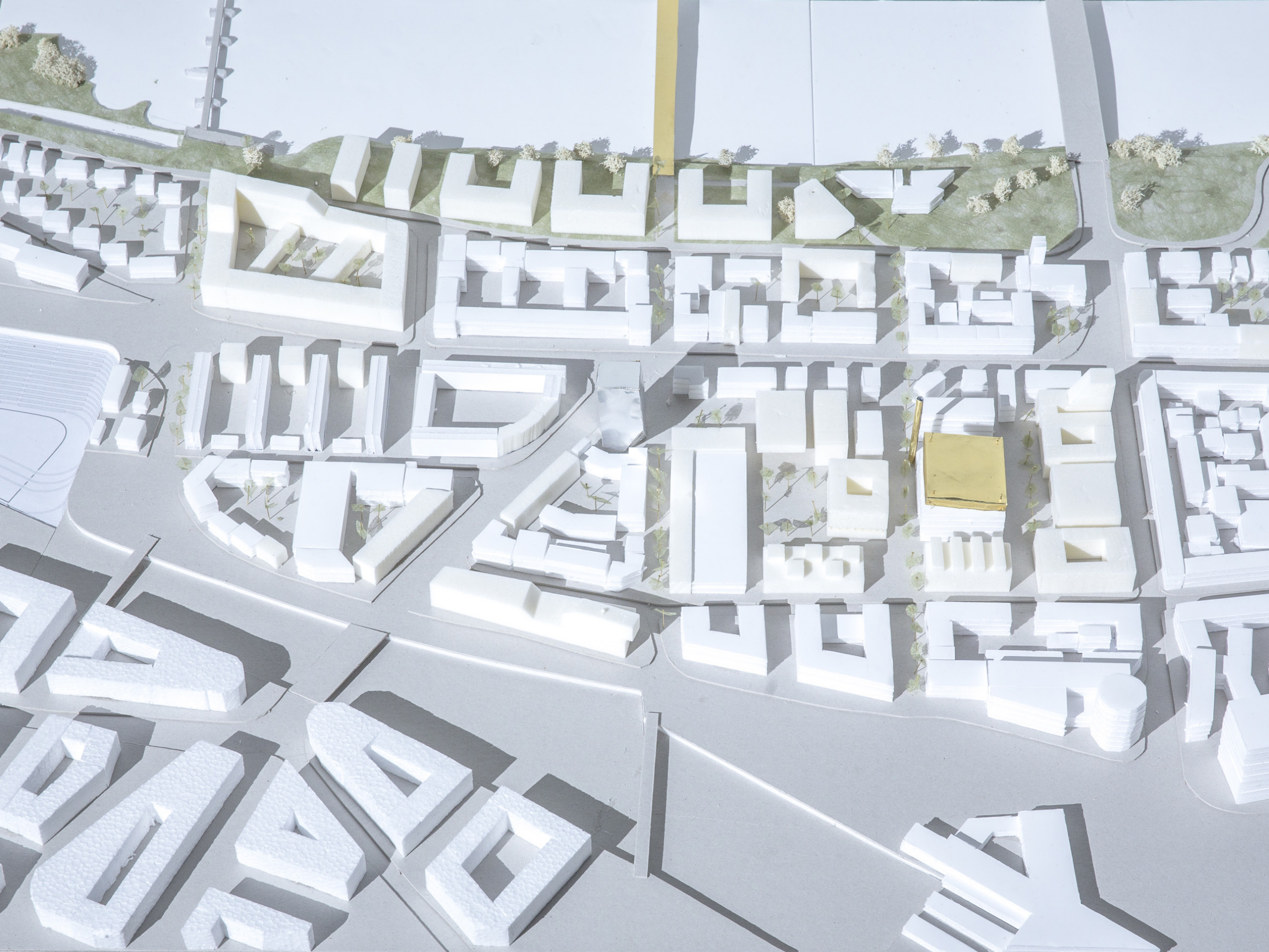

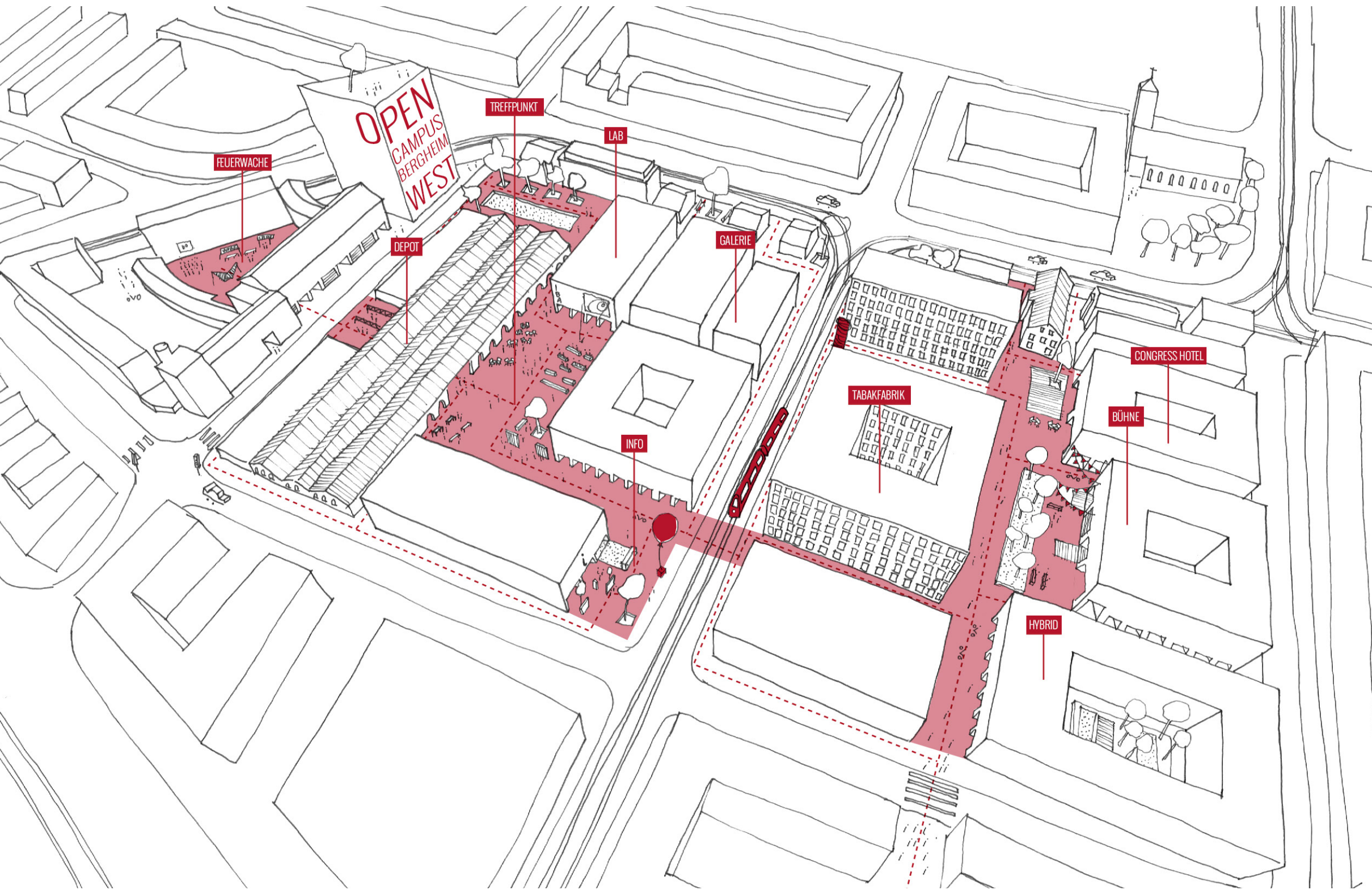

OPEN  
CAMPUS  
BERGHEIM  
WEST

FEUERWACHE

TREFFPUNKT

LAB

DEPOT

GALERIE

INFO

TABAKFABRIK

CONGRESS HOTEL

BÜHNE

HYBRID



Tram depot | forum



Tabacco factory | creative cluster



## SITE ANALYSIS & VISION

### STUDIO PHASE 1

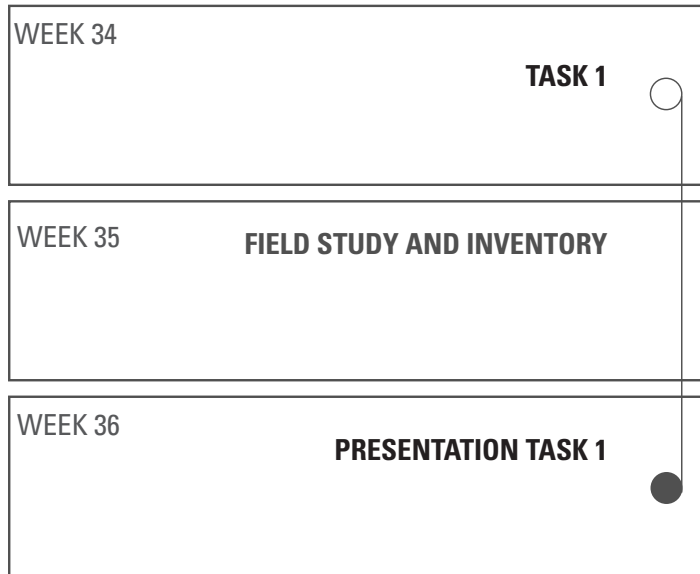

## CONCEPTS & STRATEGIES

### STUDIO PHASE 2

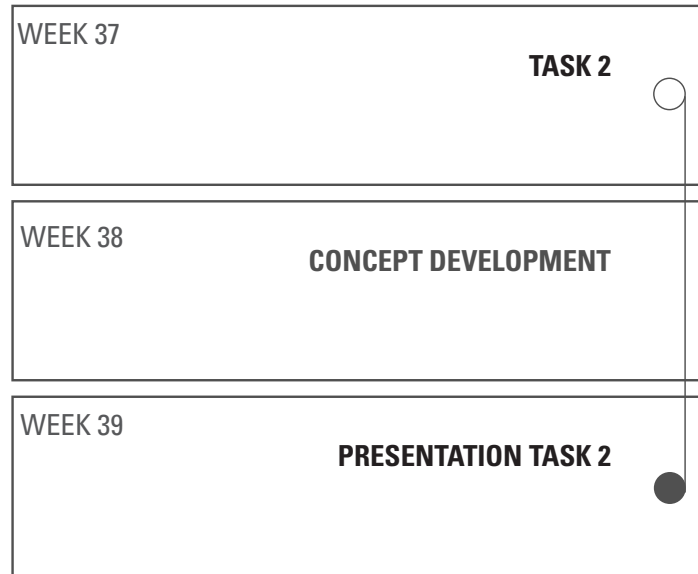

## URBAN DESIGN PROPOSAL

### STUDIO PHASE 3

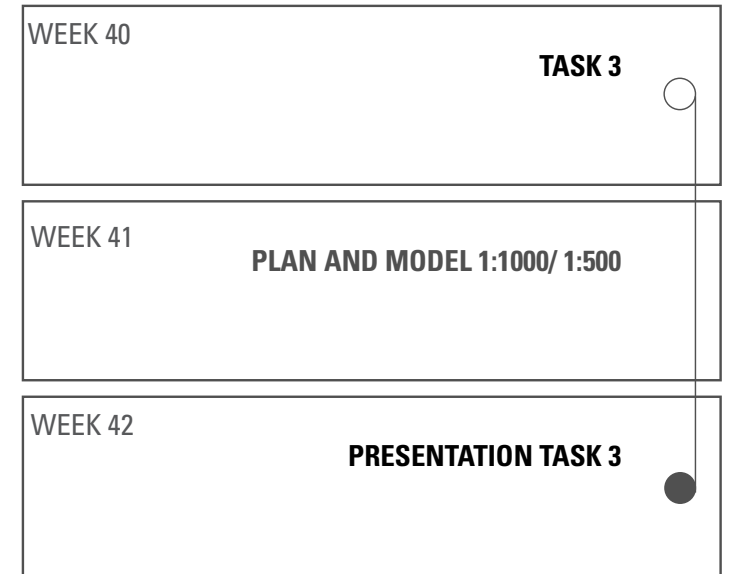

## ARCHITECTURE & LANDSCAPE

### STUDIO PHASE 4

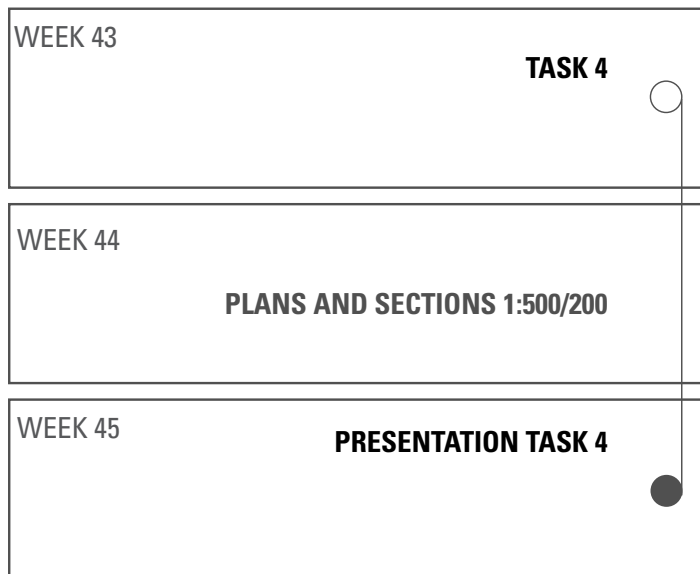

## PERSPECTIVES & DESIGN RULES

### STUDIO PHASE 5

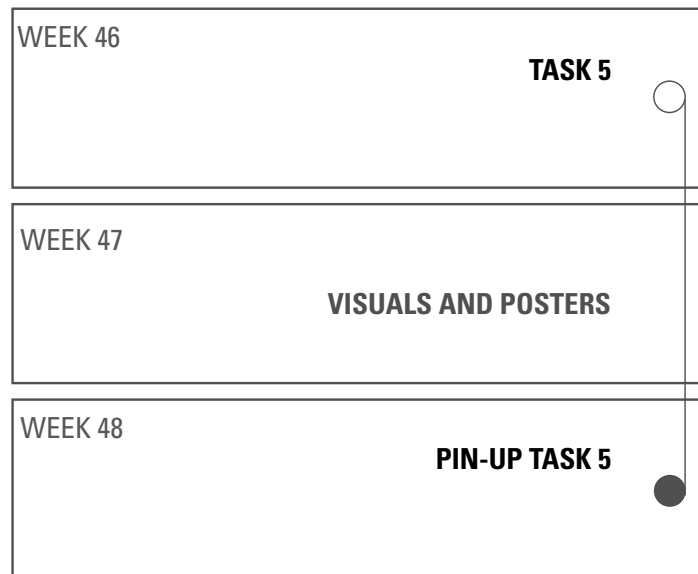

## PRESENTATION & EXHIBITION

### STUDIO PHASE 6

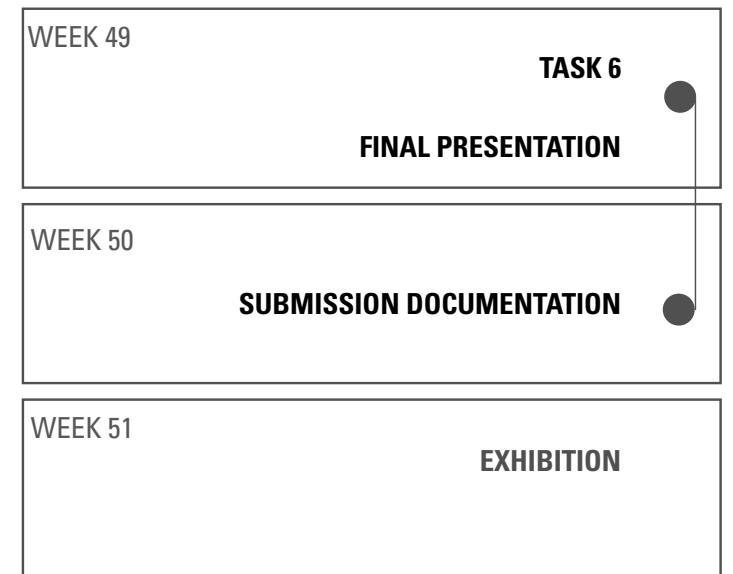

# CASE STUDIES

## LAB PHASE 1

WEEK 34  
**LECTURE URBAN DESIGN AND PLANNING**  
**TASK 1 MASTER PLAN AND TYPOLOGY STUDIES**

WEEK 35/36  
**PRESENTATIONS AND WORKSHOPS**  
**EXCURSION HEIDELBERG**

WEEK 37  
**LECTURE URBAN THEORIES**  
**TASK 2 READINGS AND ESSAY**

WEEK 38  
**LECTURE URBAN DESIGN CONCEPTS**  
**LAB MASTER PLANS**

WEEK 39  
**LECTURE URBAN TYPOLOGIES**  
**LAB BUILDING TYPOLOGIES**

WEEK 40  
**PRESENTATION TASK 1**

# URBAN THEORIES & RESEARCH

## LAB PHASE 2

WEEK 41  
**LECTURE URBAN TRANSFORMATION**  
**LAB READINGS**

WEEK 42  
**LECTURE KNOWLEDGE TERRITORIES**  
**LAB ESSAY**

WEEK 43  
**LECTURE LANDSCAPE**  
**LAB DISCUSSION**

WEEK 44  
**PRESENTATION TASK 2**

WEEK 45  
**LECTURE URBAN DESIGN RULES**

WEEK 46  
**LECTURE CONCLUSION**  
**SUBMISSION TASK 2**

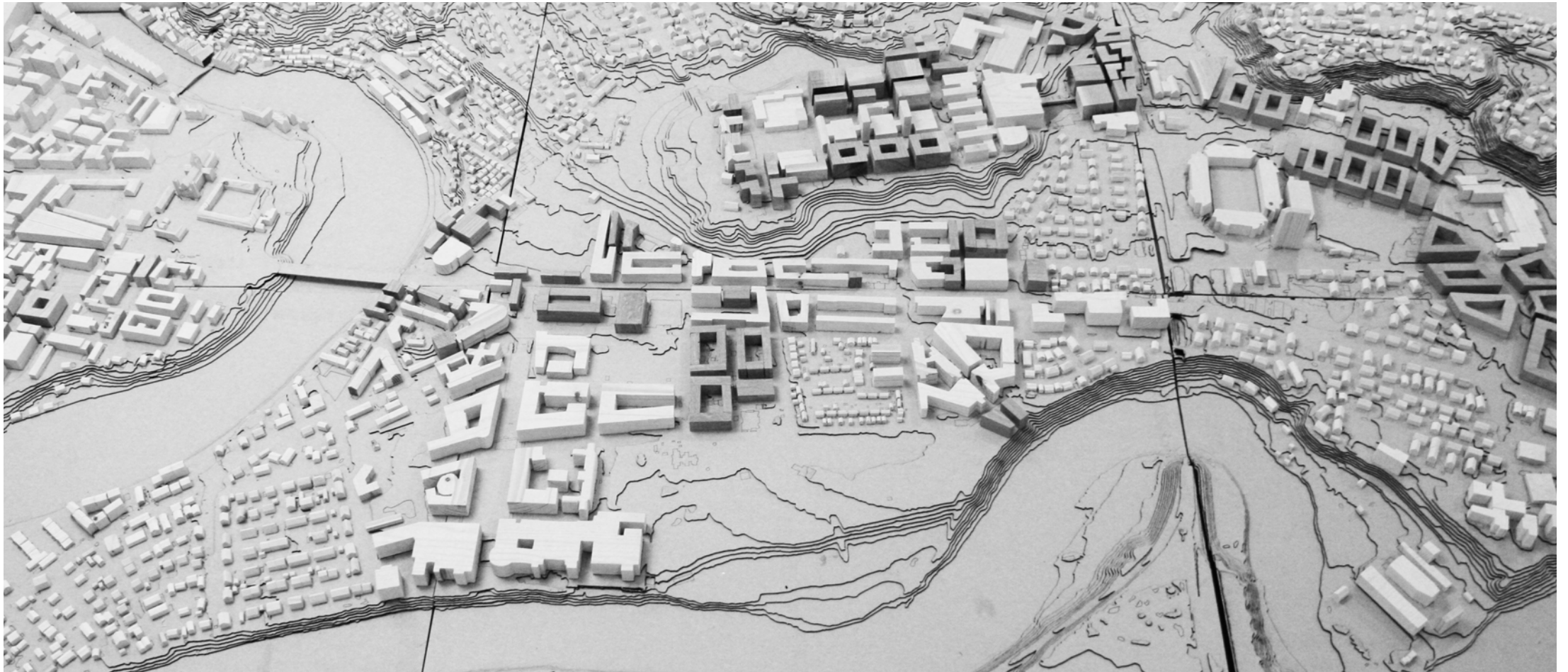

Center for Mental Health & Psychology  
Planned development  
18 700m<sup>2</sup>

KAMIPJ  
- Art-Architecture-Music-Product Design  
- Planned Development  
- Bad soil conditions this is a very uncertain site  
- 25 000m<sup>2</sup>

Health & social education - SIT sports  
- 23 000m<sup>2</sup> in teaching space  
- +5000m<sup>2</sup> for sport facilities

Student housing/  
Incubator/ pop-ups  
- Reclaimed/Restored  
buildings

Digital Faculties - Humanitaria  
70 000m<sup>2</sup>

Faculty of ICT, Electrical Engineering  
and Geology  
64 000m<sup>2</sup>

Student Centre + Library  
- 23 000m<sup>2</sup>

Student housing/  
Incubator/ pop-ups  
- Reclaimed/Restored  
buildings

NTNU 2040 buffer zone  
- Future development opportunities  
- 74 000m<sup>2</sup>

Student Housing  
- 20 000m<sup>2</sup>

Innovation Center  
- Planned Development  
- NTNU, Start-Ups and external partners  
- 28 000m<sup>2</sup>

KLP Eimdam - Office Development  
- Private development to be finished in 2017  
- Rental opportunities for NTNU during  
development phases  
- 18 850m<sup>2</sup>

Entra - Office Development  
- Private development  
- Rental opportunities for NTNU during  
development phases  
- 37 000m<sup>2</sup>



**NTNU The Adaptable Campus | Master thesis Theodor Brattøy | 2016-17**

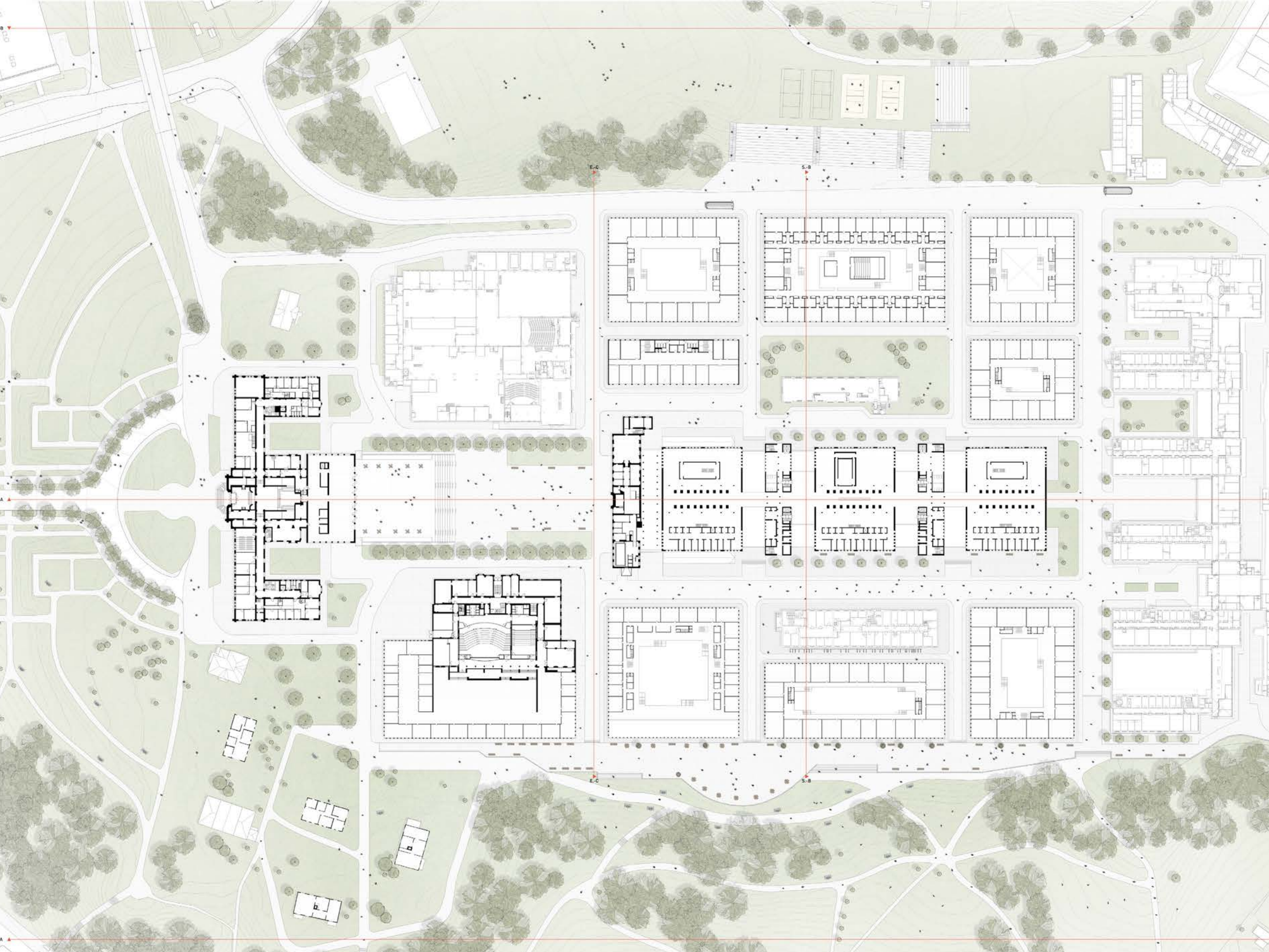

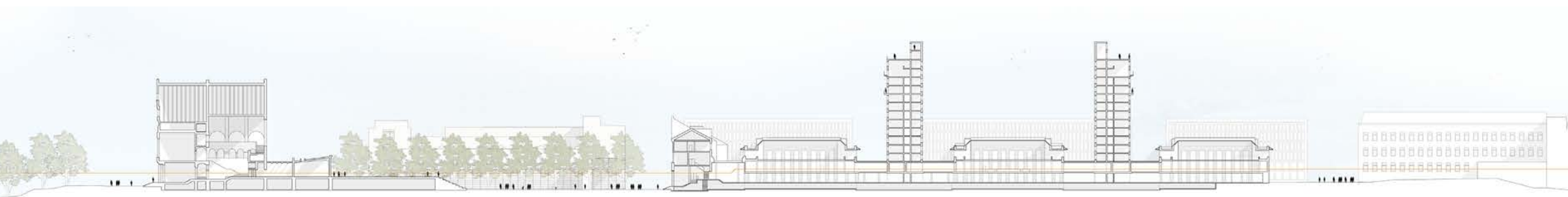





# FACTS

## INTEGRATED STUDIO AND LAB

AAR4515 URBAN DESIGN AND ARCHITECTURE STUDIO (15 ECTS)

AAR4905 URBAN LAB | THEORY, RESEARCH, PRACTICE (7,5 ECTS)

## TEAM

PROF. KERSTIN HÖGER, kerstin.hoeger@ntnu.no, +47 735 95 033

PERNILLE SCHANCHE FERAGEN, pernille.feragen@ntnu.no, +47 930 91 393

MARIUS HAULAND NÆSS

SAU | STUDIOS ARCHITECTURE AND URBANISM

## PARTNERS

IBA HEIDELBERG

CITY AND UNIVERSITY OF HEIDLEBERG

et al.

## COURSE DURATION

START 21.08.2018

END 13.12.2018

## EXCURSION HEIDELBERG

PLANNED WEEK 35 to 36

## MORE INFO

[WWW.URBANDESIGNSTUDIO.NET](http://WWW.URBANDESIGNSTUDIO.NET)



