

PHV "THE KNOWLEDGE CITY OF TOMORROW"
CONVERSION OF THE PATRICK-HENRY-VILLAGE IN HEIDELBERG

PARTNER IBA HEIDELBERG

iba.heidelberg.de/english/projects/phvision-patrick-henry-village.html

AAR4605 URBAN DESIGN AND ARCHITECTURE STUDIO | AAR4905 URBAN LAB

www.urbandesignstudio.net



Heidelberg | Baroque Style Old Town and University City



Internationale Bauausstellung
Heidelberg GmbH

Emil-Maier-Straße 16
69115 Heidelberg

T +49.6221.6586.500
E info@iba.heidelberg.de

www.iba.heidelberg.de

 **Heidelberg**
Ein Unternehmen der Stadt Heidelberg

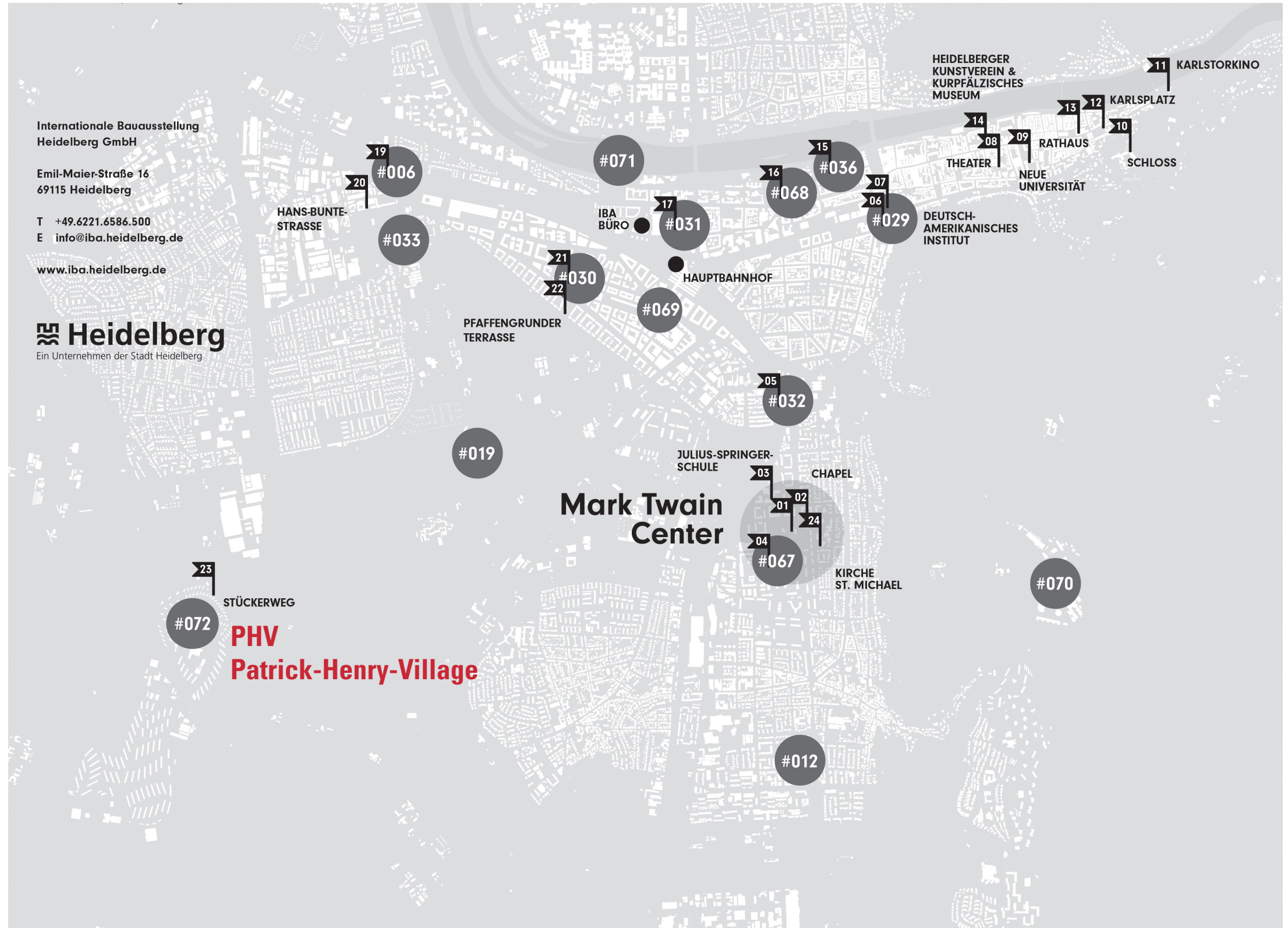



PHV | Former US military site for over 8,000 inhabitants (1947-2013), since 2015 temporary shelter for refugees (600 arrivals per day)

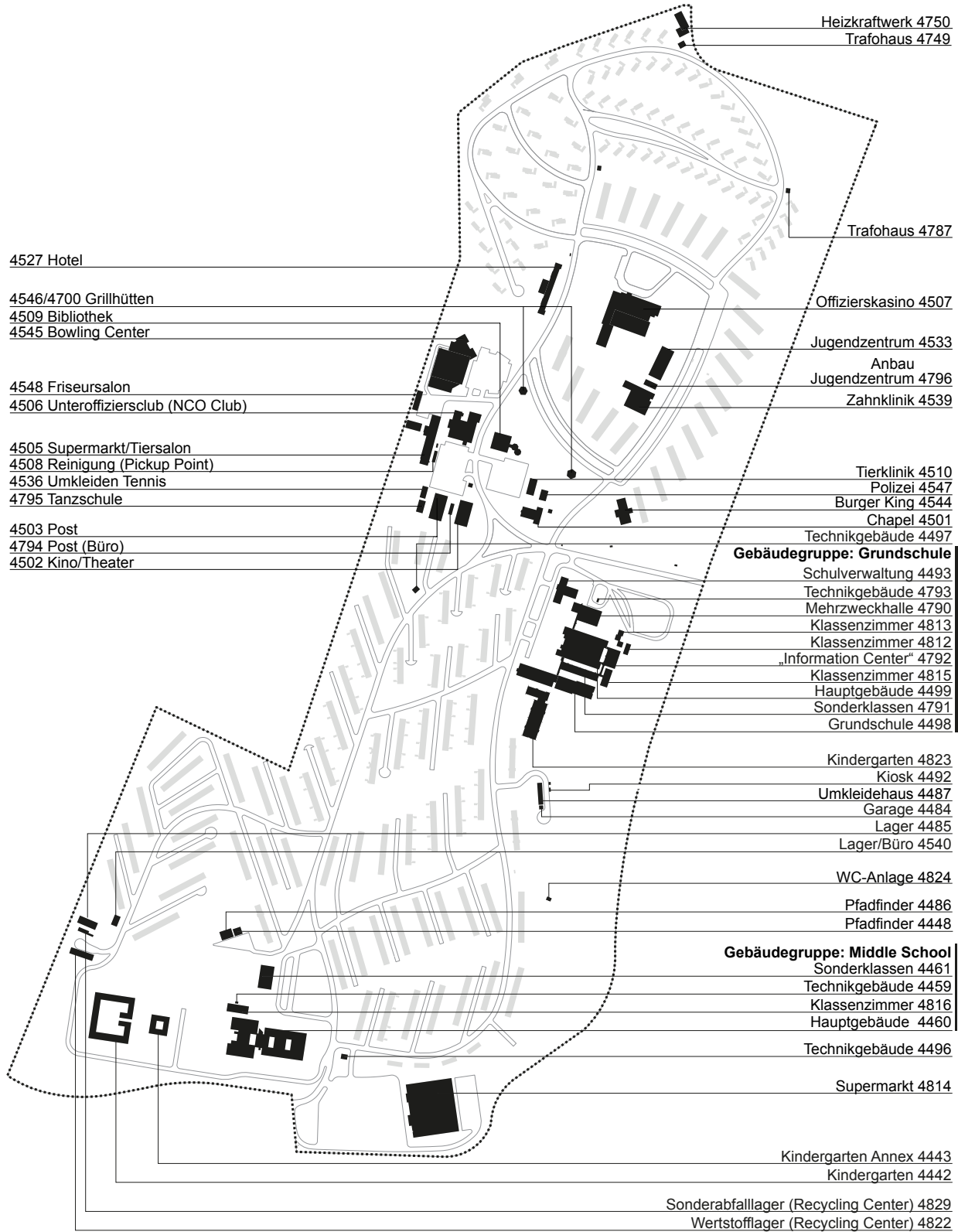



Apartment blocks and landscape



Parking and row houses



(Officer) Villas in the park



Common spaces | church and library



PHVision "The Knowledge City of Tomorrow" | IBA Heidelberg | KCAP with ASTOC, MVRDV, Carlo Ratti, Ramboll et al.



INSIDE-OUT principle



parkway



essence diagram



green heart

CLUSTER



Micro quarters

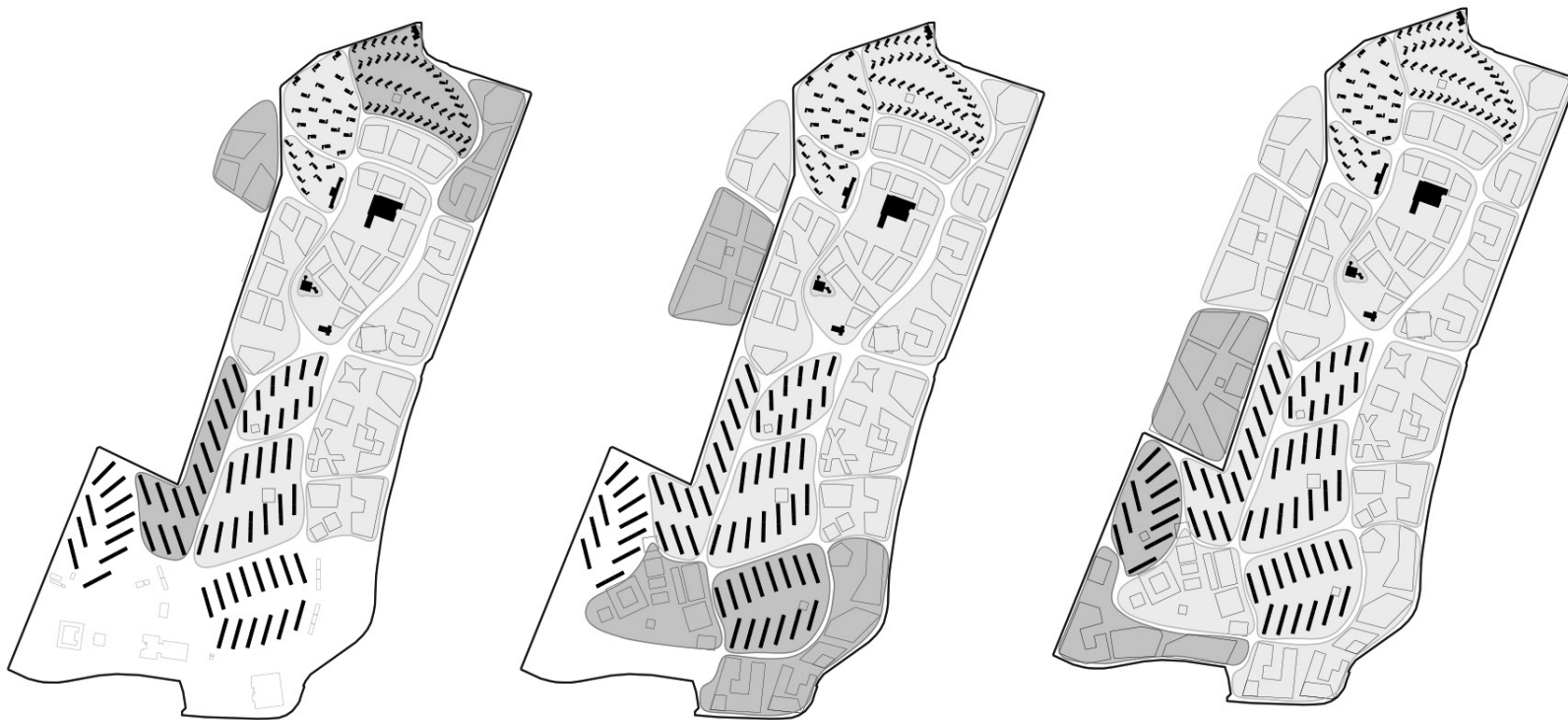
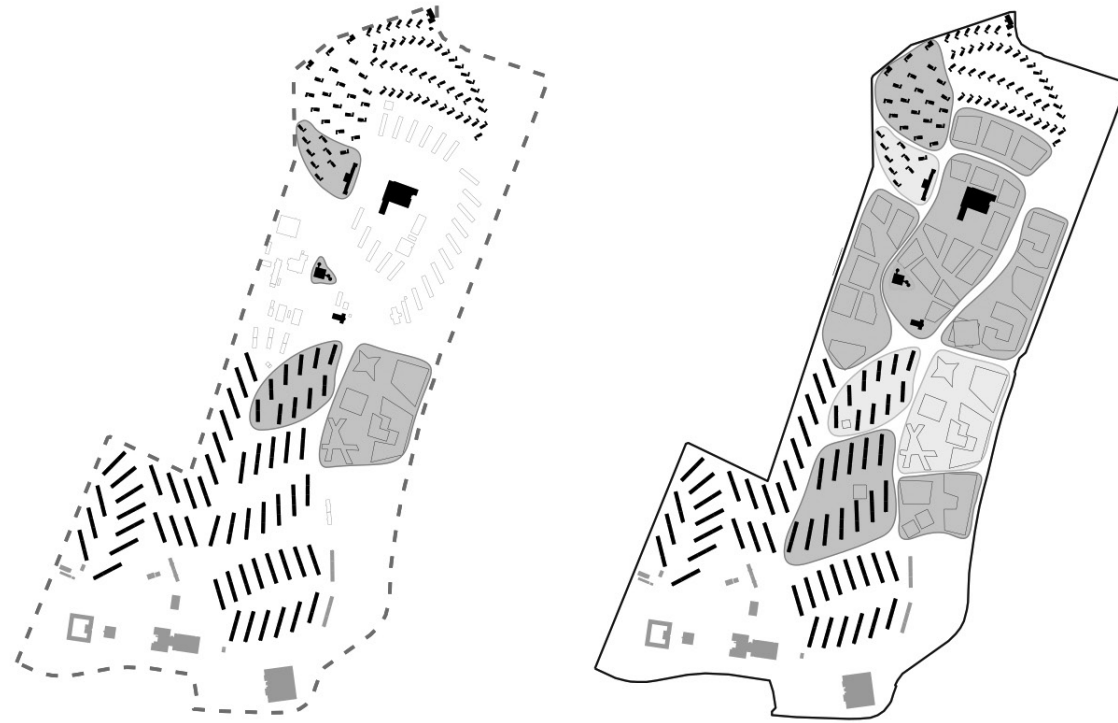

SITE ANALYSIS & VISION

STUDIO PHASE 1

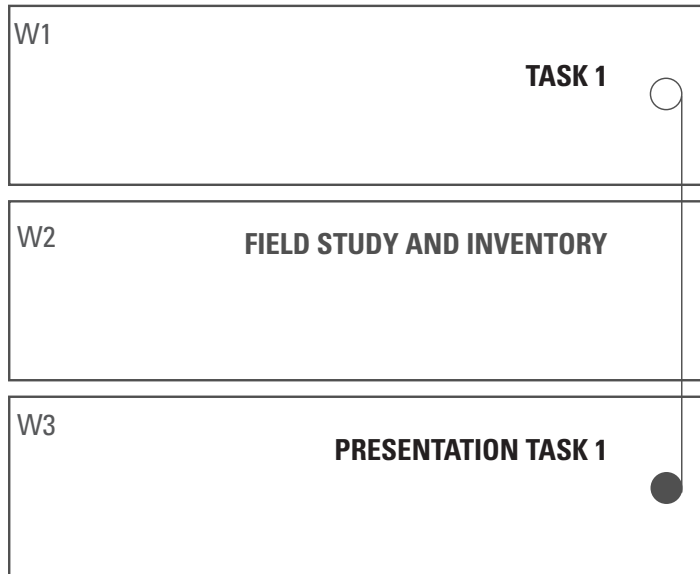

CONCEPTS & STRATEGIES

STUDIO PHASE 2

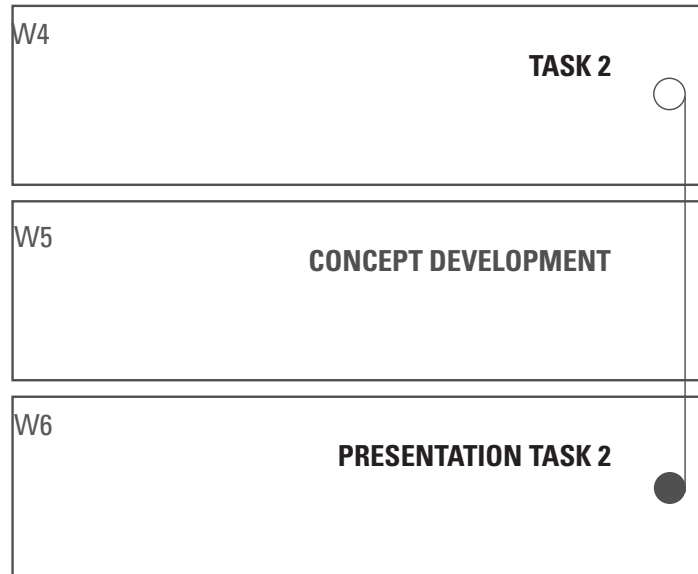

URBAN DESIGN PROPOSAL

STUDIO PHASE 3

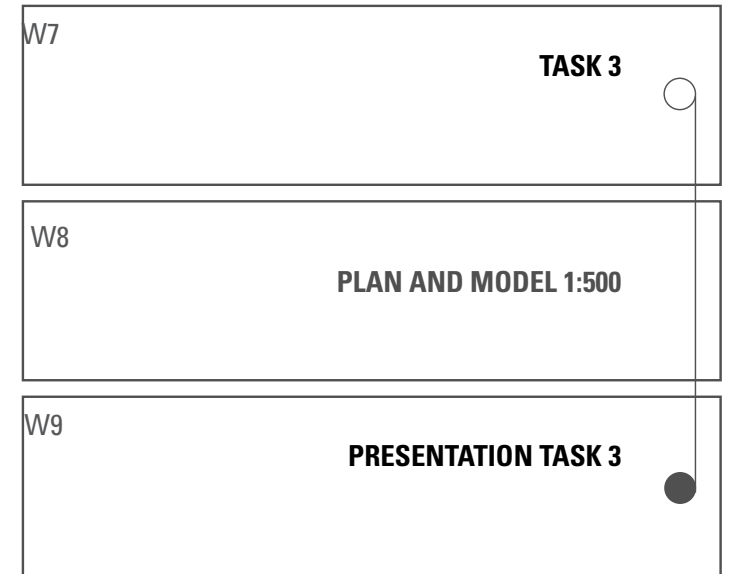

ARCHITECTURE & LANDSCAPE

STUDIO PHASE 4

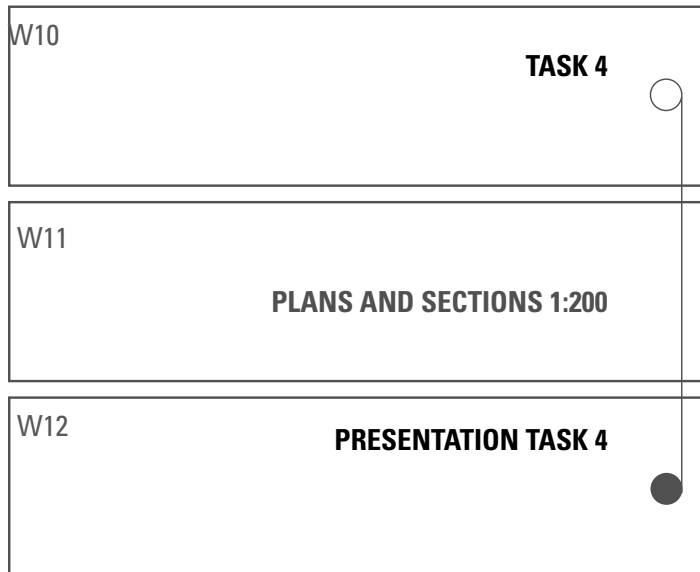

PERSPECTIVES & DESIGN RULES

STUDIO PHASE 5

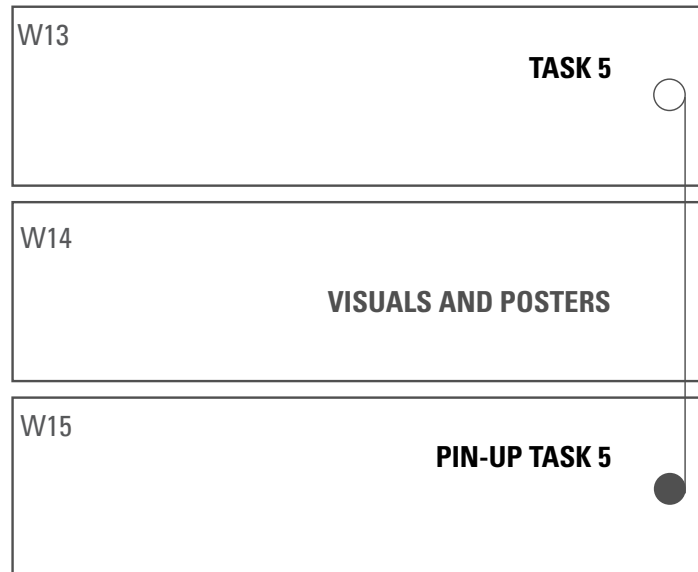

PRESENTATION & EXHIBITION

STUDIO PHASE 6

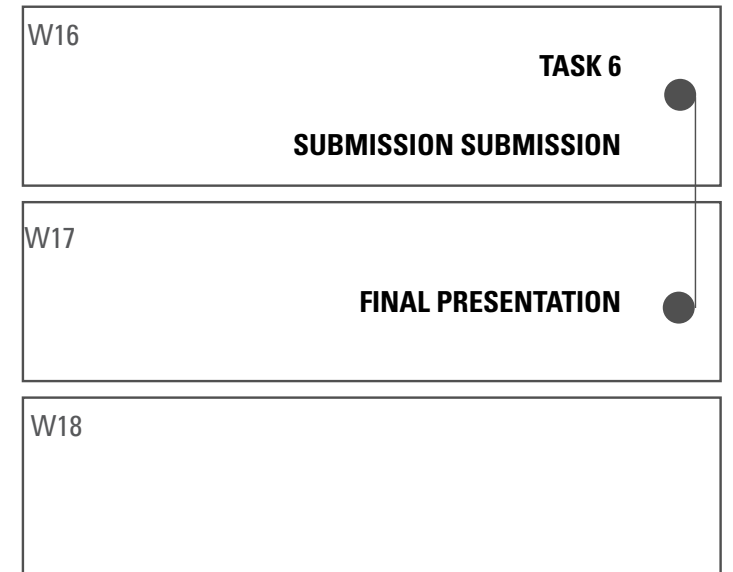

CASE STUDIES

LAB PHASE 1

W1

LECTURE URBAN DESIGN AND PLANNING

TASK 1 MASTER PLAN AND TYPOLOGY STUDIES

W2

STAKEHOLDER PRESENTATIONS

EXCURSION HEIDELBERG

W3

LECTURE URBAN THEORIES

TASK 2 BOOK REVIEW

W4

LECTURE URBAN DESIGN CONCEPTS

LAB MASTER PLANS

W5

LECTURE URBAN TYPOLOGIES

LAB TYPOLOGIES

W6

PRESENTATION TASK 1

URBAN THEORIES & RESEARCH

LAB PHASE 2

W7

LECTURE URBAN TRANSFORMATION

LAB READINGS

W8

LECTURE KNOWLEDGE TERRITORIES

LAB ESSAY

W9

LECTURE CITY LANDSCAPE

LAB DISCUSSION

W10

PRESENTATION TASK 2

W11

LECTURE URBAN DESIGN RULES

W12

LECTURE CONCLUSION

SUBMISSION TASK 2



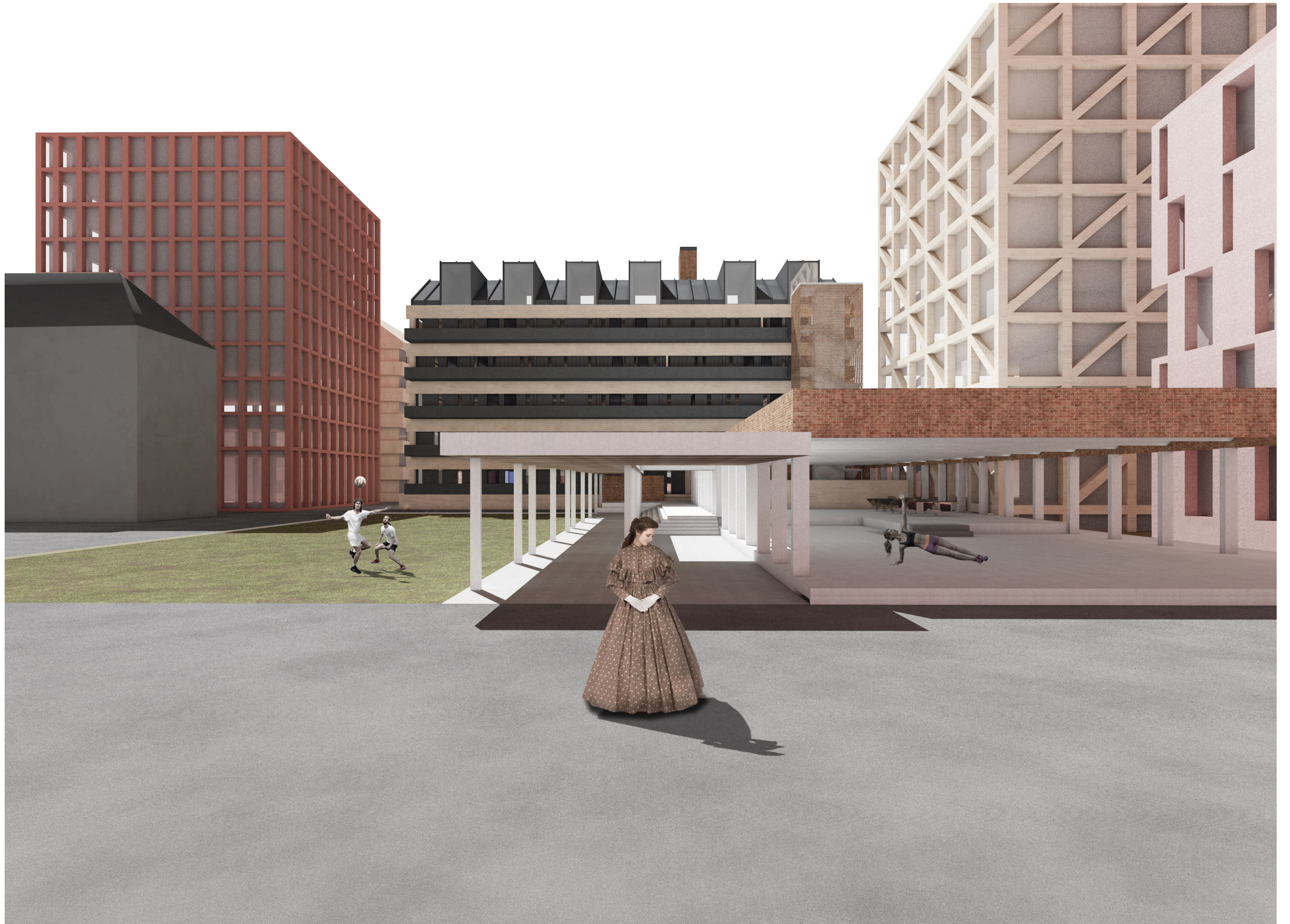



BYPLANACEU 1:500

- KENNY REBROUCE
- KISSORANGE REBROUCE
- NY REBROUCE
- FLEESKWAER
- HUISWAANEN
- EFERSOCCUET
- GELSENWALLEN

FACTS

INTEGRATED STUDIO AND LAB

AAR4605 URBAN DESIGN AND ARCHITECTURE STUDIO (15 ECTS)

AAR4905 URBAN LAB | THEORY, RESEARCH, PRACTICE (7,5 ECTS)

TEAM

PROF. KERSTIN HÖGER, kerstin.hoeger@ntnu.no, +47 735 95 033

MARIUS HAULAND NÆSS

TEACHERS STUDIOS ARCHITECTURE AND URBANISM

VIT.ASS. NN

PARTNERS

IBA HEIDELBERG

CITY OF HEIDELBERG

ARCHITECTS AND URBANISTS OF PHVision

DURATION

START 04.02.2019

END 07.06.2019

EXCURSION HEIDELBERG | VOLUNTARY

ONE WEEK IN FEBRUARY/ MARCH 2019

INTENSIVE THIRD COURSE | RECOMMENDED

IN JANUARY

MORE INFO

iba.heidelberg.de/english/projects/phvision-patrick-henry-village.html

www.urbandesignstudio.net



Your are invited to contribute visionary projects for the PHV to become " A Model Knowledge City of Tomorrow"!